

DR UN BRAHMACHARI STREET
LOUDON STREET

SHORT STREET

DRIVE WAY OF PRE. NO. - 18/1, LOUDON STREET

EXISTING PLAN
SCALE-1:150

EXISTING STRUCTURE TO BE DEMOLISHED

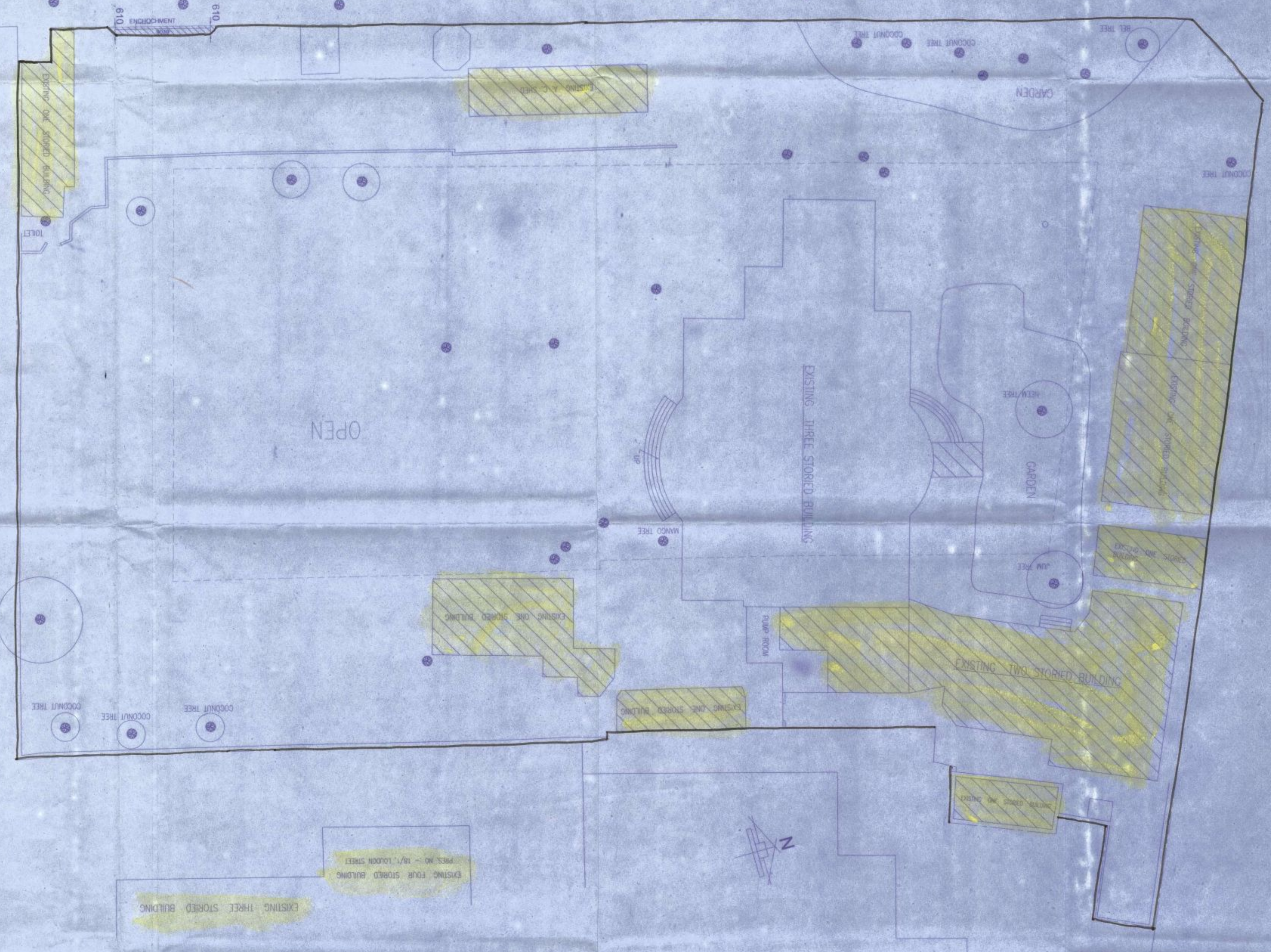

TWELVE STORED BUILDING
PREMISES NO. 18, LOUDON STREET

For E&A DEVELOPERS PRIVATE LIMITED
 BHABHUNE DEVELOPERS PRIVATE LIMITED
 NITYANAND MERCHANTS LIMITED
 SURESHKANTH PRIVATE LIMITED
 SURESHKANTH TRADING LLP
 WISEBACK TOWERS LLP

(Authorized signatory)



<p>DR. SUNITI EDWIN Registered Architect No. 108/1, Loudon Street, Chennai - 600 029 E-mail: sunitiedwin@gmail.com Phone: 98401 23456</p>	
<p>PROJECT: TWELVE STORED BUILDING PREMISES NO. 18, LOUDON STREET</p>	<p>CLIENT: HARBH SANON CONSULTANT OF ARCHITECTURE REGISTRATION No: CPV/17255</p>
<p>TITLE: EXISTING STRUCTURE</p>	<p>DATE: 15/05/2024</p>
<p>SCALE: 1:150</p>	<p>PROJECT NO: 18/1/2024</p>
<p>DATE OF ISSUE: 15/05/2024</p>	<p>DATE OF VALIDITY: 15/05/2024</p>
<p>PROJECT LOCATION: NO. 18, LOUDON STREET, CHENNAI - 600 029</p>	<p>PROJECT AREA: 1000 SQ. METERS</p>
<p>PROJECT TYPE: EXISTING STRUCTURE</p>	<p>PROJECT STATUS: APPROVED</p>
<p>PROJECT VALUE: 10000000 INR</p>	<p>PROJECT RISK: LOW</p>
<p>PROJECT COMPLETION: 12 MONTHS</p>	<p>PROJECT DELAY: 0 MONTHS</p>
<p>PROJECT BUDGET: 10000000 INR</p>	<p>PROJECT COST: 10000000 INR</p>
<p>PROJECT ROI: 10%</p>	<p>PROJECT NPV: 10000000 INR</p>
<p>PROJECT IRR: 10%</p>	<p>PROJECT PV: 10000000 INR</p>
<p>PROJECT PAYBACK PERIOD: 10 YEARS</p>	<p>PROJECT SENSITIVITY: LOW</p>
<p>PROJECT RISK: LOW</p>	<p>PROJECT COMPLIANCE: YES</p>
<p>PROJECT APPROVAL: YES</p>	<p>PROJECT REVISION: 0</p>
<p>PROJECT CANCELLED: NO</p>	<p>PROJECT ARCHIVED: NO</p>
<p>PROJECT DELETED: NO</p>	<p>PROJECT EXPORTED: NO</p>
<p>PROJECT PRINTED: YES</p>	<p>PROJECT SAVED: YES</p>
<p>PROJECT OPENED: YES</p>	<p>PROJECT CLOSED: YES</p>
<p>PROJECT LOCKED: NO</p>	<p>PROJECT UNLOCKED: YES</p>
<p>PROJECT PROTECTED: NO</p>	<p>PROJECT UNPROTECTED: YES</p>
<p>PROJECT UNPROTECTED: YES</p>	<p>PROJECT PROTECTED: NO</p>
<p>PROJECT LOCKED: NO</p>	<p>PROJECT UNLOCKED: YES</p>
<p>PROJECT UNLOCKED: YES</p>	<p>PROJECT LOCKED: NO</p>
<p>PROJECT PROTECTED: NO</p>	<p>PROJECT UNPROTECTED: YES</p>
<p>PROJECT UNPROTECTED: YES</p>	<p>PROJECT PROTECTED: NO</p>

Before starting any construction the plan must be sanctioned and all the conditions as specified in the plan should be fulfilled. The validity of the written permission to execute the work is subject to the above conditions.

Design of all Structural Members including that of the foundation should conform to Standards specified in the National Building Code of India.

All Building Materials to be used in construction should conform to standards specified in the National Building Code of India.

Non Commencement of Excavation and Erection of Formwork for Foundation.

THE SANCTION IS VALID UP TO 10.11.12.2012

Necessary steps should be taken for the safety of the lives of the adjoining public and private properties during construction.

APPROVED
ASSISTANT ENGINEER (3)
BUNDLICH, MD. 1/11

Approved subject to Compliance of regulation of West Bengal Fire Services, if any.

OFFICE OF THE EXECUTIVE ENGINEER
BUILDING DEPARTMENT
DATE: 05.07.12
1/11

RESIDENTIAL BUILDINGS

The building materials that will be started on Roof or other construction of G. Floor, whichever is earlier may be seized forthwith by the K.M.C. at the cost and risk of the owner.

CONSTRUCTION SITE SHALL BE MAINTAINED TO PREVENT MOSQUITO BREEDING AS REQUIRED UNDER (1) & (2) OF SECTION 130 & 131 OF THE W.B. ACTS. BASEMENT CURING SITES, OPEN ACCEPTABLES ETC. MUST BE SHUTTED COMPLETELY TWICE A WEEK.

A suitable pond has to be provided for pumping untreated water for the disposal to the flushing cisterns and urinals in the building. Increase untreated water from street main is not available.

DEVIATION WOULD MEAN DEMOLITION
Approved by: *A. B. Chakrabarty*
The Building Committee

The sanction refers to the proposed plan shown in red and the Executive Engineers makes no admission as to the correctness of the plan.



* Provision for use of solar energy in the form of solar heater and / or solar photo-cells shall be provided as required under Rule 147 of Building rules, 2009 and completion certificate will not be issued in case of building without having such provision *